

SMITSEN UP-2 ULTRA PORTABLE

User manual and parts list



Stitch type:	Single thread stitch (101)
Material thickness	Up to 3 mm
Power consumption	90 Watt
Weight	3.5 Kilo
Voltage	AC 230v~240v 50/60Hz
Rpm no Load	5040
Rpm Load	4800

SMITSEN UP-2 ULTRA PORTABLE

User manual and parts list

INTRODUCTION

The Smitsen UP2 Ultra Portable Bag Closer has been designed to stitch paper, plastic, net, jute, raffia, textile etc. bags and materials with different thickness from thin to thick. Wholly metallic built, the well processed components ensures a great performance also with heavy materials and hard duty work. The machine is light and handy, allowing easy and fast operation. The large overarm allows to stitch thin, medium, and thick bags and materials. The one thread chain stitch gives a very strong, simple and quick bag stitching. The alternated looper avoids the thread's entanglement and the stitch failure.

IMPORTANT SAFETY ANNOUNCEMENT

- Personal injury may result if the following safety precautions are not observed.
- Be sure the area surrounding machine is free of all hazards such as fire, water, oil, rubbish or anything that can cause Injury.
- Do not operate machine in an explosive area or under wet conditions. The machine is not an explosion-proof type nor water-proof.
- Do not operate machine before reading instruction manual.
- Do not operate machine on voltages other than specified for the machine.
- Be sure machine is connected to building electrical safety ground (earth).
- Be sure power is off before performing machine maintenance,
- Parts replacement, adjustments or cleaning.
- Do not operate machine with guards and covers removed.
- Do not touch the knife, needle, or moving parts when machine is in operation.
- Be sure the machine is placed on a smooth (level) surface when performing maintenance, parts replacement, adjustments, cleaning or storage.
- Be sure the material to be sewn or closed complies with the machine specifications.

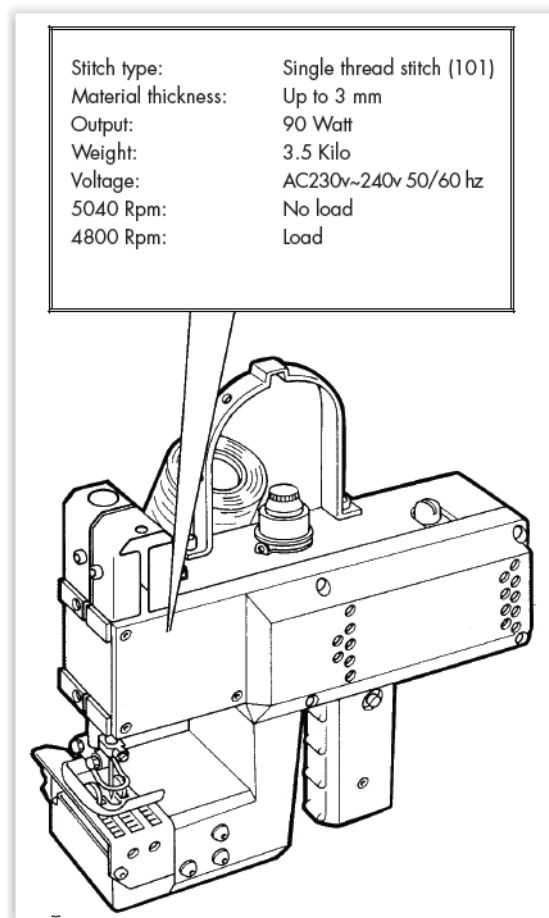

SMITSEN UP-2 ULTRA PORTABLE

User manual and parts list

Safety and adjustments

Safety

The machine has to be disconnected from the power supply by pulling out the main plug before:

1. Threading needle and looper.
2. replacing any parts such as needle presser foot, throat plate, looper, spreader, feed dog, needle guard, folder, fabric guide etc.
3. Leaving the workplace and when the work place is unattended.
4. Doing maintenance work.

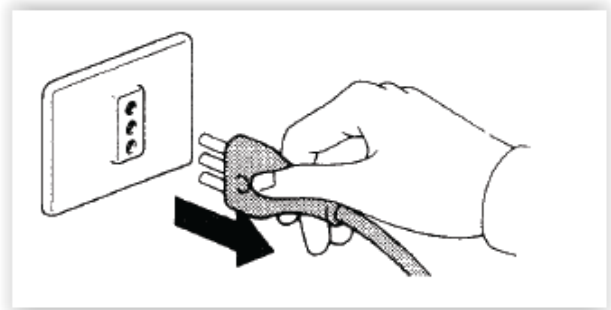

Wall sockets for machines with ground wire must be properly grounded.

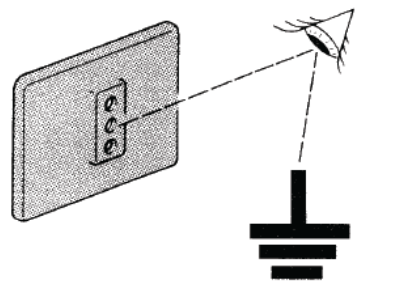

Do not block the thermal hole of the motor.

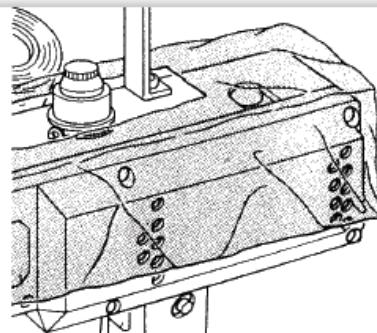

SMITSEN UP-2 ULTRA PORTABLE

User manual and parts list

Routine and maintenance must be done by an electrician or under direction and supervision of specially skilled personnel.

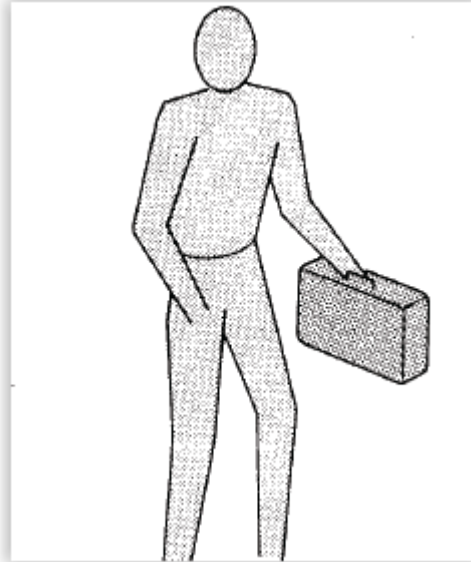

Installation and adjustments

Thread the machine as shown, and make sure the thread end is about 10cm out of the needle's eye. Turn the tension knob, regulated tension until the machine sews and chains off perfectly.

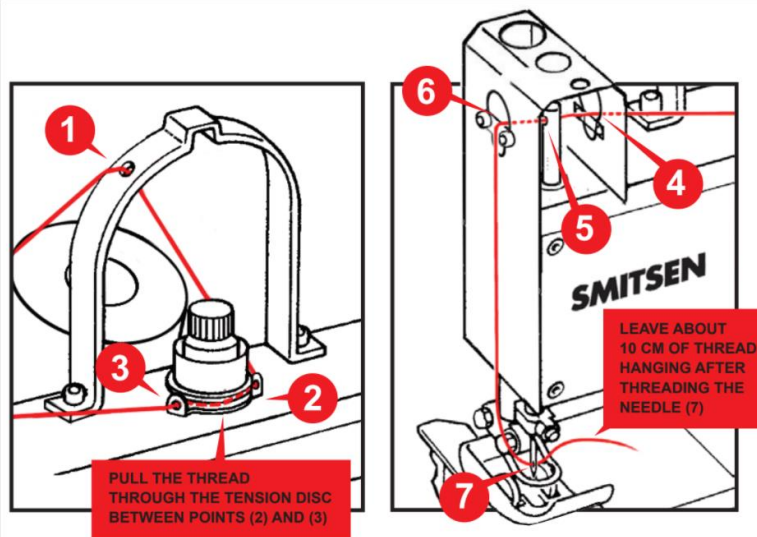

SMITSEN UP-2 ULTRA PORTABLE

User manual and parts list

Use a sample to test the quality of stitching. Place a sample under the press foot and push the start button.

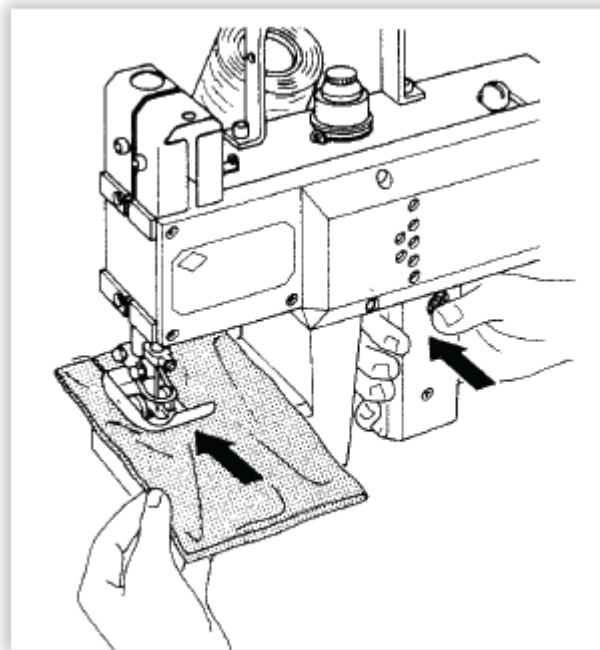

Operation

Stitching

If the chain stitch is tight or loose, please turn the tension knob to regulate until the machine sews and makes a perfect chain.

Clockwise: tight
Counterclockwise: loose

Suggestion:
Turn the tension knob 90 degrees until the machine sews and makes a perfect chain.

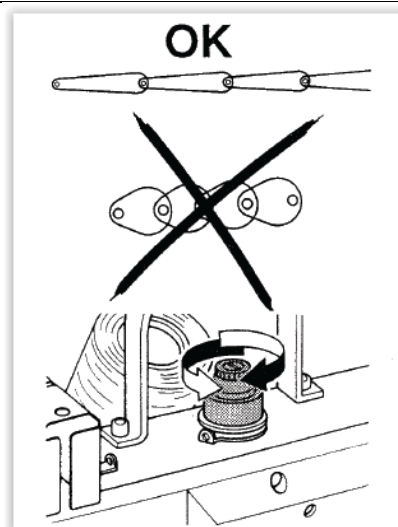

SMITSEN UP-2 ULTRA PORTABLE

User manual and parts list

Changing the needle

Loosen the screw for the needle and draw out the needle. Insert the shank of the new needle as far as it will go into the needle seat and with the flat on the shank facing to the front. Retighten screw for the needle on the flat of the needle shank and thread the needle eye.

Warning:

Pull out the mains plug before changing the needle!

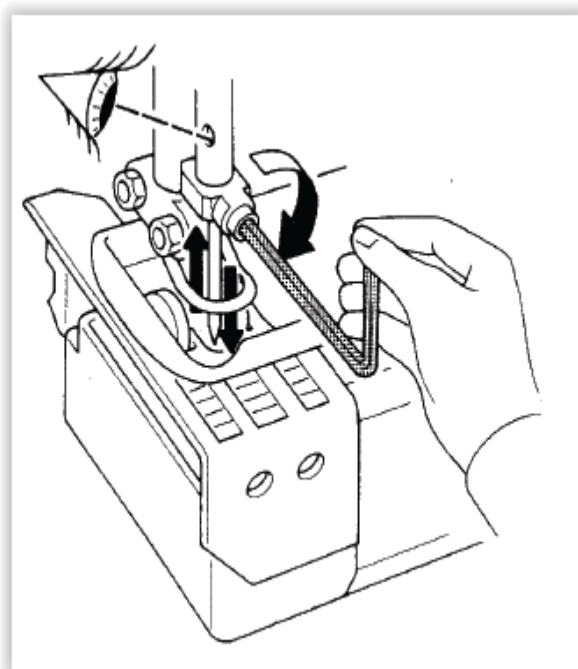

Looper and needle adjustments

1. Needle position: When the needle goes to the lowest position, the space between looper point and needle center is about 3.5~4.5mm.

2. When the looper point is in the center of the needle (behind the needle), the space between looper point and needle eye is about 2.5 ~3.2 mm. The distance between the looper point and the needle is as close as possible to the needle, without deflecting the needle.

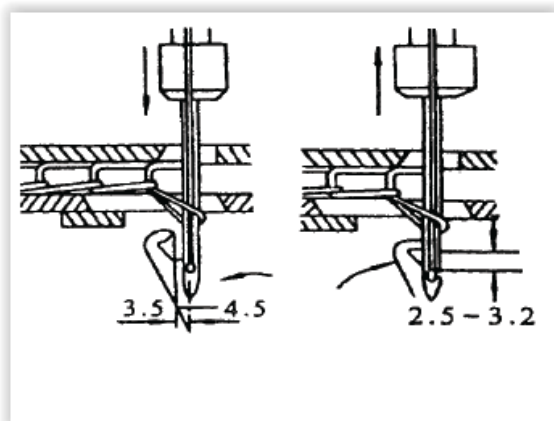

SMITSEN UP-2 ULTRA PORTABLE

User manual and parts list

Turn motor handwheel in the operating direction until the needle is in its upmost position above the throat plate.

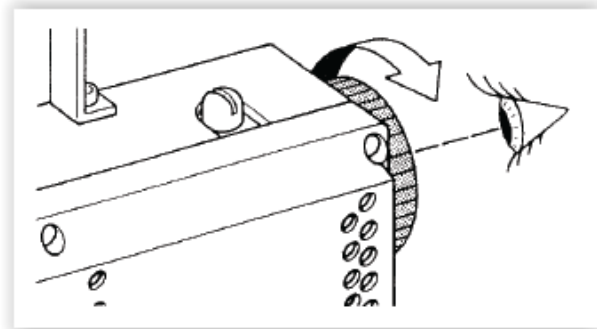

Loosen the screw for the looper and replace the looper. Retighten screw for the looper.

Warning:

Do not loosen the screw **A** which positions the looper.

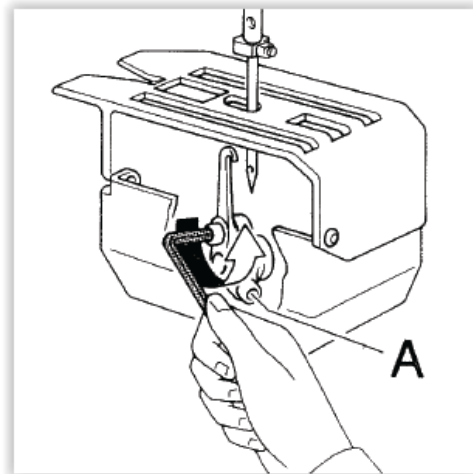

The presser foot pressure is regulated with the regulating screw.

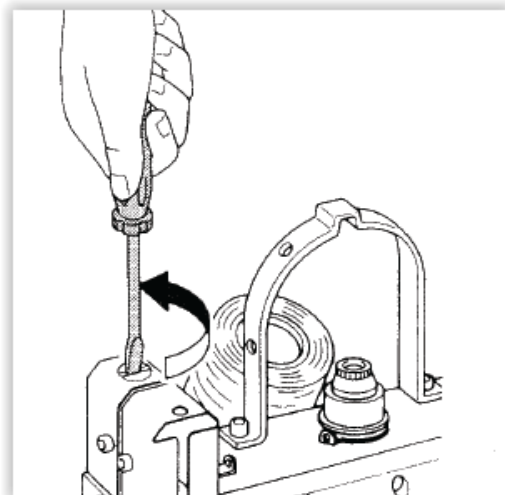

SMITSEN UP-2 ULTRA PORTABLE

User manual and parts list

Cleaning the machine

Clean the machine at least once a week from lint.

Open the hinged cover, and the punched cover.

Close the covers after cleaning.

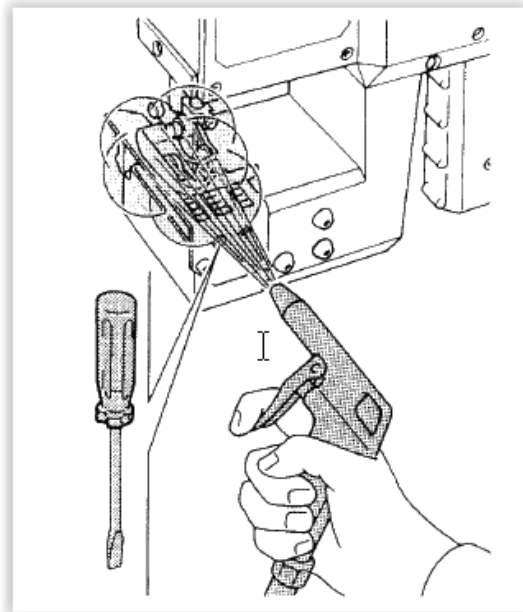

SMITSEN UP-2 ULTRA PORTABLE

User manual and parts list

Lubrication

The machine has to be oiled before use.

Monthly:

Oil the thread cutter, needle bar and pressure foot bar.

Release the screw shown in the figure.
Lubricate with grease, retighten the screw.

Warning:

Do not drop oil and grease on the belt.

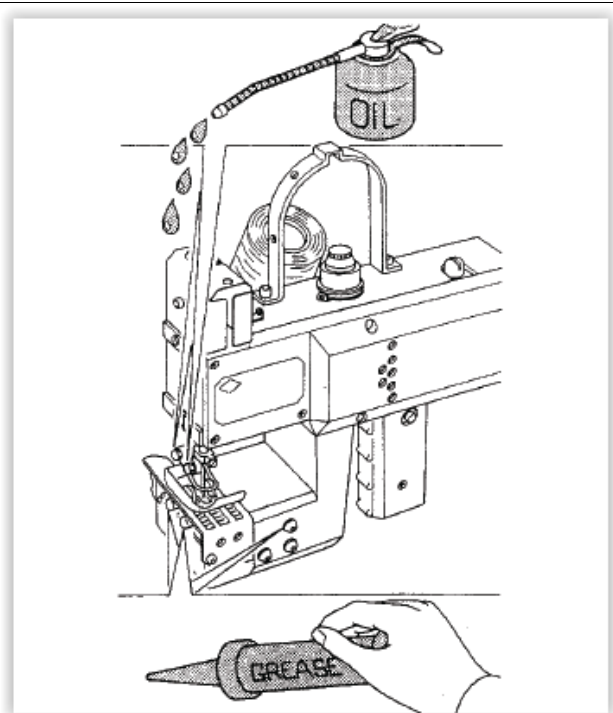

Yearly:

Open the cover, lubricate with grease on the feaddog gear, looper cam and moving parts of needle bar breaker.

Warning:

Do not drop oil and grease on the belt.

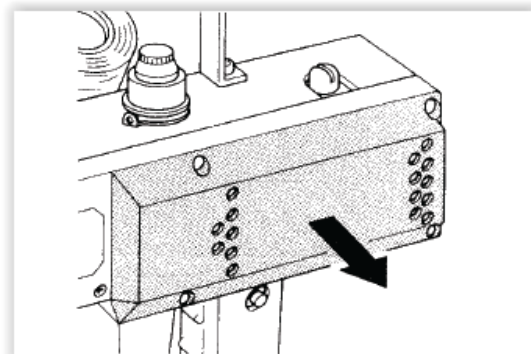

SMITSEN UP-2 ULTRA PORTABLE

User manual and parts list

Maintenance

Yearly:

Inspect the length of the carbon brushes (2), and replace them if the carbon part has a short length, or replace them if the motor runs irregular. Release the brush-cap , and pull-out the brushes.

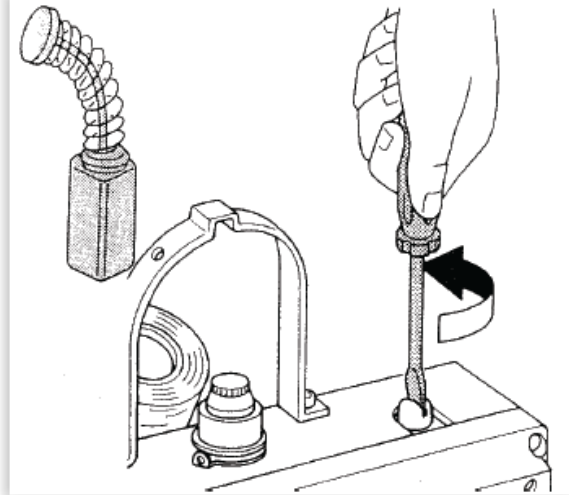

SMITSEN UP-2 ULTRA PORTABLE

User manual and parts list

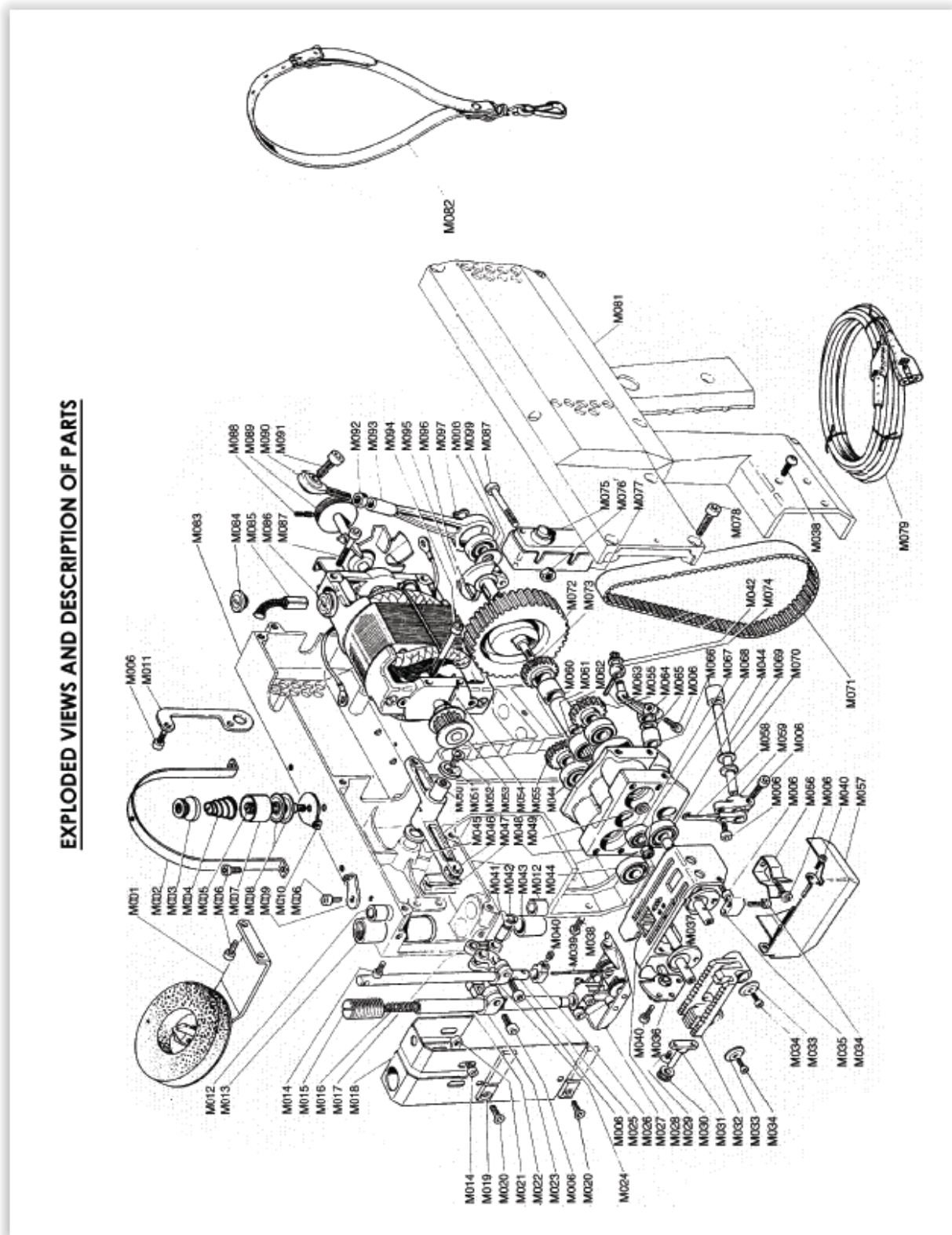

SMITSEN UP-2 ULTRA PORTABLE

User manual and parts list

SPARE PARTS LIST

M001	Cone holder	M043	Pressure bar bushing	M085	Carbon brush
M002	Thread guide bracket	M044	Bearing	M086	Motor
M003	Tension knob	M045	Lever shaft washer	M087	Screw
M004	Tension spring	M046	Lever	M088	Position screw
M005	Tension screw	M047	Pressure bar bracket slot	M089	Pulley
M006	Screw	M048	Looper feed base	M090	Bearing
M007	Tension cup	M049	Washer	M091	Screw
M008	Tension disc	M050	Lever shaft	M092	Screw nut
M009	Thread guide	M051	Front lever shaft washer	M093	Connecting rod
M010	Thread disc	M052	Sunk screw	M094	Screw
M011	Pulley cover	M053	Motor pulley	M095	Crank main shaft
M012	Bushing	M054	Pin	M096	Key
M013	Bushing	M055	Gear	M097	Spring ring
M014	Screw	M056	Cover spring clip	M098	Bearing
M015	Pressure foot spring screw	M057	Cover	M099	Bearing washer
M016	Pressure foot spring	M058	Looper		
M017	Joint	M059	Looper lever		
M018	Covering panel	M060	Busing		
M019	Upper thread guide	M061	Bushing		
M020	Sunk screw	M062	Axis front bushing		
M021	Thread stretcher	M063	Pin		
M022	Pressure bar	M064	Looper crank		
M023	Pressure bar bracket	M065	Washer		
M024	Needle bar joint	M066	Looper shaft bushing		
M025	Needle bar	M067	Bearing		
M026	Needle clamp	M068	Screw nut		
M027	Pressure foot assembly	M069	Looper shaft		
M028	Throat plate base	M070	Washer		
M029	Sunk screw	M071	Timing belt		
M030	Thread cutter bushing	M072	turbine wheel		
M031	Thread cutter slide bar	M073	Central gear		
M032	Feed dog	M074	Crank ball		
M033	Feed dog washer	M075	Switch		
M034	Screw	M076	Screw		
M035	Needle guard	M077	Switch base		
M036	Thread Cutter	M078	Screw		
M037	Feed dog shaft	M079	Power lead		
M038	Screw	M080	Transformer		
M039	Needle	M081	Front cover		
M040	Screw	M082	Hanging belt		
M041	Joint pin	M083	Main body		
M042	Spring ring	M084	Carbon brush cap		